

COTTAGE GROVE AVE.

57th STREET

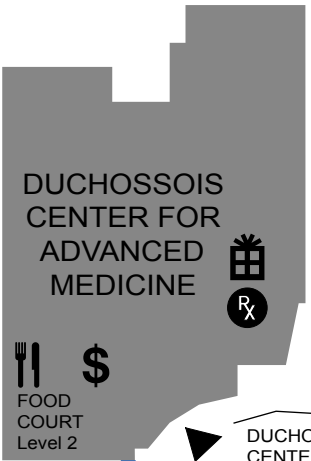

COMER CHILDREN'S HOSPITAL ENTRANCE OPEN 24 HOURS

MARYLAND AVE.



DREXEL AVE.

J L MAIN ELEVATORS NOTED WITH LETTER

OTHER ELEVATORS

MAIN CORRIDORS

LEVEL 2 BRIDGES / CORRIDORS

GIFT SHOP

CAFETERIA / FOOD COURT

COFFEE SHOP

ATM CASH STATION

PHARMACY



THE UNIVERSITY OF CHICAGO HOSPITALS



ELLIS AVE.

POST OFFICE

BOOKSTORE

58th STREET

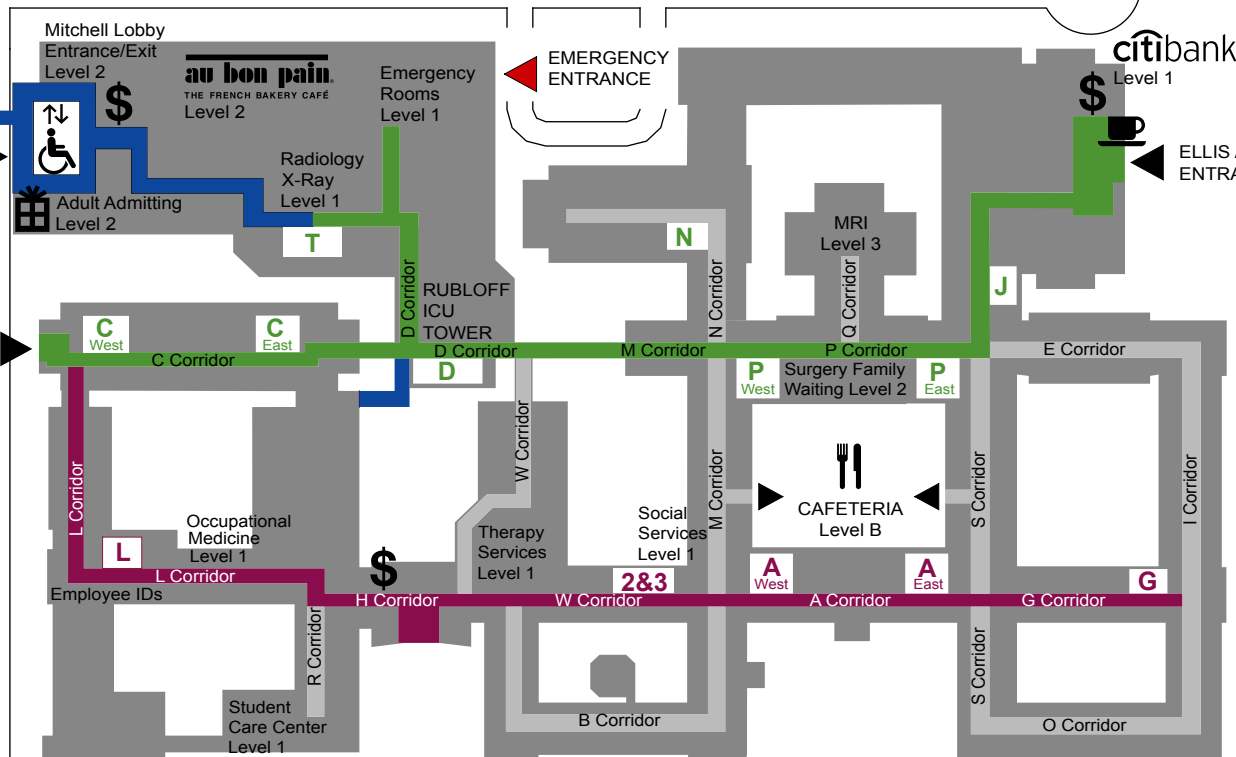
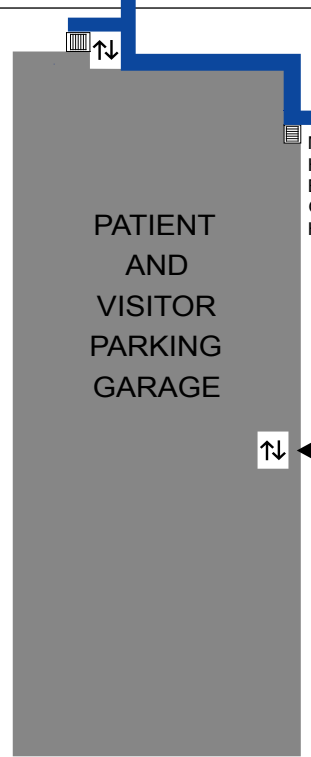

59th STREET